

# HYPRO PUMP PARTS

## All 9303C and 9303S Series Pumps

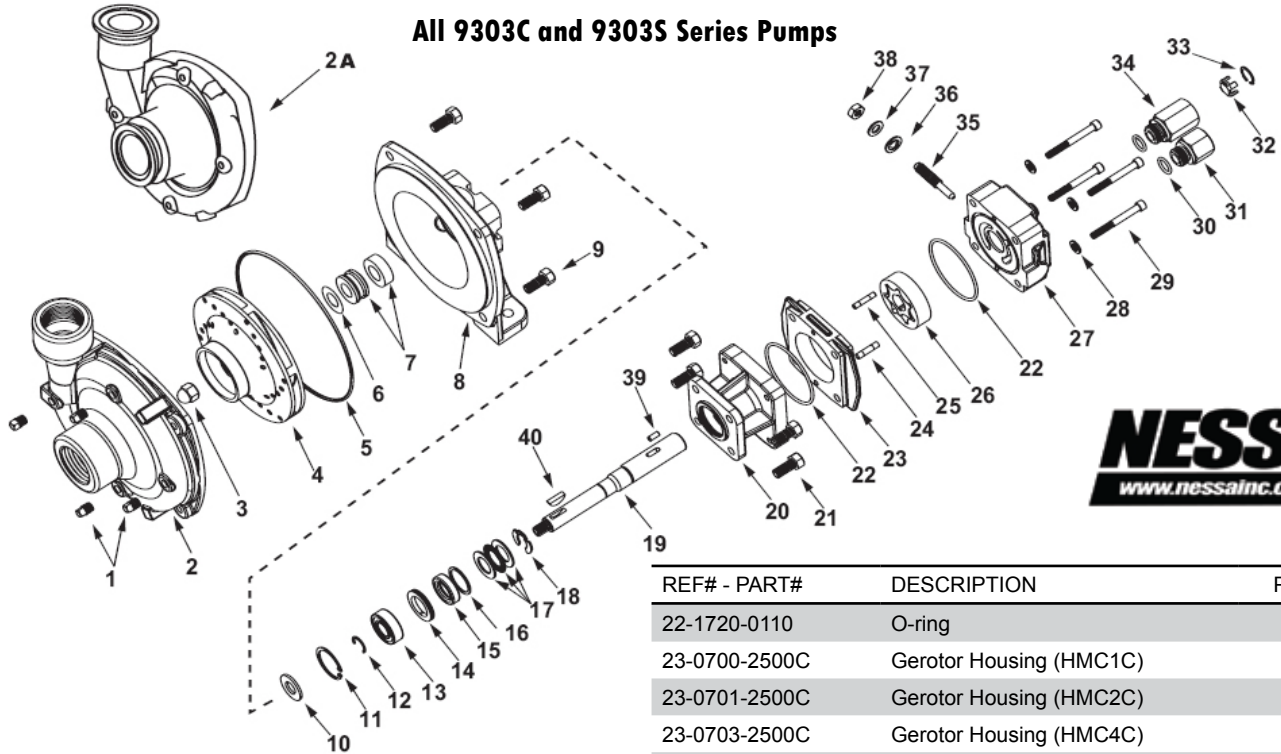

REF# - PART#	DESCRIPTION	PRICE
1-2406-0007	Pipe plug	\$ .70
2-0150-9000C	Pump Casting (9303C)	145.00
2-0150-9000S	Pump Casting (9303S)	433.00
3-2253-0002	Nut stainless steel	4.10
4-0401-9100P	Impeller, Nyglass	34.50
4-0402-9100P	Impeller, Polypropylene	34.50
5-1720-0083	O-ring, body seal	2.45
6-1700-0100	Rubber Gasket	3.55
7-2120-0009	Mechanical seal, Viton	39.00
7-3430-0589	Mechanical seal, silicon carbide	162.90
8-0750-9300C	Mounting Flange	101.00
8-0756-9300S	Mounting Flange	557.00
9-2210-0020	Cap screw	.65
9-2210-0125	Cap screw, stainless steel	1.00
10-1410-0056	Slinger	1.00
11-1820-0013	Retaining Ring	1.00
12-1810-0014	Snap Ring	1.00
13-2000-0010	Ball bearing, sealed	7.90
14-1410-0073	Spacer for shaft	4.95
15-2104-0005	Shaft Seal	28.00
16-1410-0074	Seal Spacer	1.00
17-2029-0014	Thrust Bearing Assem-1-bearing & 2- races	15.50
18-1810-0026	Snap Ring	1.00
19-0509-2500	Shaft (HM2C & HM4C) 6-3/4" long	161.00
19-0511-2501	Shaft (HM1C & HM5C) 7-1/2" long	169.00
20-0151-2500C	Motor Body w/main bearing	181.00
21-2210-0005	Hex Head Cap Screw	1.00

REF# - PART#	DESCRIPTION	PRICE
22-1720-0110	O-ring	1.00
23-0700-2500C	Gerotor Housing (HMC1C)	87.00
23-0701-2500C	Gerotor Housing (HMC2C)	95.50
23-0703-2500C	Gerotor Housing (HMC4C)	87.00
23-0704-2500C	Gerotor Housing (HMC5C)	93.00
24-1600-0044	Dowel Pin (HM1C & HM5C)	13.50
24-1600-0045	Dowel Pin (HM2C & HM4C)	10.50
25-1600-0037	Dowel Pin (HM1C & HM5C)	13.50
25-1600-0042	Dowel Pin (HM2C & HM4C)	10.50
26-3900-0022	Gerotor (HM1C)	141.00
26-3900-0023	Gerotor (HM2C)	129.00
26-3900-0025	Gerotor (HM4C)	135.00
26-3900-0048	Gerotor (HM5C)	144.00
27-0251-2500C	Motor End Plate, w/ main bearing	108.00
28-2270-0039	Washer	1.00
30-1720-0108	O-ring	1.00
31-3360-0021	Pressure Port Adapter	9.05
32-3260-0068	Poppet	3.65
33-1820-0038	Retaining Ring	2.75
34-3320-0049	Check Valve Assy	30.25
35-3220-0029	Valve Stem	5.30
36-1700-0047	Gasket	3.10
37-2270-0027	Washer	1.40
38-2250-0038	Lock Washer	1.00
39-1610-0031	Roll Pin (HM1C & HM5C)	3.40
39-1610-0032	Roll Pin (HM2C & HM4C)	5.80
40-1610-0012	Woodruff Key	1.00
2500-0009C	Hydraulic Motor (HM1C)	466.00
2500-0010C	Hydraulic Motor (HM2C)	466.00
2500-0012C	Hydraulic Motor (HM4C)	461.00
2500-0018C	Hydraulic Motor (HM5C)	466.00
3430-0332	Repair Kit w/Ref. 5-6-7	44.50
3430-0178	Repair Kit (Hyd Motors 1-2-3-4-5C)	48.70